

NORTHAMPTON BOROUGH COUNCIL

LICENSING ACT 2003

LICENSING SUB COMMITTEE

A Meeting of the Licensing Sub-Committee will be held at The Holding Room, St. Giles Square, Northampton, NN1 1DE. on Friday, 13 May 2016 at 10:00 am

D Kennedy
Chief Executive

AGENDA

- 1. WELCOMES**
- 2. DECLARATIONS OF INTEREST**
- 3. NEW GRANT PREMISES LICENCE - LITTLE EURO, 10 WELLINGTON PLACE**

(Copy herewith)

4. EXCLUSION OF PUBLIC AND PRESS

The Chair to move:

“That the public and press be excluded from the remainder of the meeting on the grounds that there is likely to be disclosure to them of such categories of exempt information as defined by Section 100(1) of the Local Government Act 1972 as listed against such items of business by reference to the appropriate paragraph of Schedule 12A to such act.”

SUPPLEMENTARY AGENDA

Exempted Under Schedule 12A of the Local Government Act 1972

Para No:-

PROCEDURES FOR LICENSING SUB-COMMITTEE HEARING

- **Welcome** – Chairman welcomes the Applicant, Representors, Responsible Authorities and Interested Parties and introduces members of the sub-committee (+ other officers e.g. Solicitor, Licensing Officer, Democratic Services Officer etc).
- **Declarations of Interest by Councillors**
- **Reason for Hearing** – to be outlined by the **Licensing Officer** or the **Chair**.
- **Format of the hearing** – an explanation of the format of the proceedings:
 1. **Applicant** (or his/her representative) will address the sub-committee first and put their case.
 2. **The Chair** leads an examination of the **Applicant's case**. First, the panel may ask questions and then the Chair invites Responsible and Interested Parties to participate. Questions may only relate to the points made by the applicant.
 3. **The Representors** (and responsible and Interested Parties) then state their case.
 4. **The Chair** leads an examination of the **Representor's case**.

Each party will be given an equal maximum period of time in which to present their case and may, if given permission by the Chair, question any other party.

- **Summing Up**
 - By the Representors
 - By the Applicant
- **Sub-committee retires** – and may call for the Solicitor for advice if required.
- **Sub-Committee deliver their decision and reasons for their decision at the conclusion of the meeting IF:**
 1. Application for conversion of existing licence
 2. Application for conversion of existing club certificate
 3. Application by holder of justices' licence for grant of personal licence
 4. Application for conversion and variation of premises licence (including variation of DPS)
 5. Application for conversion and variation of club premises certificate
 6. Counter notice following police objection to temporary event notice
 7. Review of Premises Licence following Closure Order

In all other cases, the Sub-committee delivers its decision and reasons for its decision within five working days beginning with the day on which the hearing was held.

If you require any further information regarding this meeting please contact Democratic Services on 01604 837722 or democraticservices@northampton.gov

Agenda Item 3



Northampton
Application for a premises licence
Licensing Act 2003

For help contact
licensing@northampton.gov.uk
Telephone:

* required information

Section 1 of 19

You can save the form at any time and resume it later. You do not need to be logged in when you resume.

System reference This is the unique reference for this application generated by the system.

Your reference You can put what you want here to help you track applications if you make lots of them. It is passed to the authority.

Are you an agent acting on behalf of the applicant?

Yes No

Put "no" if you are applying on your own behalf or on behalf of a business you own or work for.

Applicant Details

* First name

* Family name

* E-mail

Main telephone number

Include country code.

Other telephone number

Indicate here if the applicant would prefer not to be contacted by telephone

Is the applicant:

- Applying as a business or organisation, including as a sole trader
- Applying as an individual

A sole trader is a business owned by one person without any special legal structure. Applying as an individual means the applicant is applying so the applicant can be employed, or for some other personal reason, such as following a hobby.

Continued from previous page...

Address

* Building number or name

* Street

District

* City or town

County or administrative area

* Postcode

* Country

Agent Details

* First name

* Family name

* E-mail

Main telephone number Include country code.

Other telephone number

Indicate here if you would prefer not to be contacted by telephone

Are you:

- An agent that is a business or organisation, including a sole trader
- A private individual acting as an agent

A sole trader is a business owned by one person without any special legal structure.

Your Address

* Building number or name

* Street

District

* City or town

County or administrative area

* Postcode

* Country

Address official correspondence should be sent to.

Continued from previous page...

I/we, as named in section 1, apply for a premises licence under section 17 of the Licensing Act 2003 for the premises described in section 2 below (the premises) and I/we are making this application to you as the relevant licensing authority in accordance with section 12 of the Licensing Act 2003.

Premises Address

Are you able to provide a postal address, OS map reference or description of the premises?

- Address OS map reference Description

Postal Address Of Premises

Building number or name	LITTLE EUROPE INTERNATIONAL SUPERMARKET
Street	10 WELLINGTON PLACE
District	BARRACK ROAD
City or town	NORTHAMPTON
County or administrative area	
Postcode	NN1 3RQ
Country	United Kingdom

Further Details

Telephone number	0
Non-domestic rateable value of premises (£)	4,200

Section 3 of 19

APPLICATION DETAILS

In what capacity are you applying for the premises licence?

- An individual or individuals
- A limited company
- A partnership
- An unincorporated association
- A recognised club
- A charity
- The proprietor of an educational establishment
- A health service body
- A person who is registered under part 2 of the Care Standards Act 2000 (c14) in respect of an independent hospital in Wales
- A person who is registered under Chapter 2 of Part 1 of the Health and Social Care Act 2008 in respect of the carrying on of a regulated activity (within the meaning of that Part) in an independent hospital in England
- The chief officer of police of a police force in England and Wales
- Other (for example a statutory corporation)

Confirm The Following

- I am carrying on or proposing to carry on a business which involves the use of the premises for licensable activities
- I am making the application pursuant to a statutory function
- I am making the application pursuant to a function discharged by virtue of Her Majesty's prerogative

Section 4 of 19

INDIVIDUAL APPLICANT DETAILS

Applicant Name

Is the name the same as (or similar to) the details given in section one?

- Yes No

If "Yes" is selected you can re-use the details from section one, or amend them as required. Select "No" to enter a completely new set of details.

First name

Family name

Is the applicant 18 years of age or older?

- Yes No

Continued from previous page...

Applicant Postal Address

Is the address the same as (or similar to) the address given in section one?

If "Yes" is selected you can re-use the details from section one, or amend them as required. Select "No" to enter a completely new set of details.

Yes No

Building number or name	<input type="text"/>
Street	<input type="text"/>
District	<input type="text"/>
City or town	<input type="text" value="NORTHAMPTON"/>
County or administrative area	<input type="text"/>
Postcode	<input type="text"/>
Country	<input type="text" value="United Kingdom"/>

Applicant Contact Details

Are the contact details the same as (or similar to) those given in section one?

If "Yes" is selected you can re-use the details from section one, or amend them as required. Select "No" to enter a completely new set of details.

Yes No

E-mail	<input type="text"/>
Telephone number	<input type="text"/>
Other telephone number	<input type="text"/>

Section 5 of 19

OPERATING SCHEDULE

When do you want the premises licence to start? / /
dd mm yyyy

If you wish the licence to be valid only for a limited period, when do you want it to end / /
dd mm yyyy

Provide a general description of the premises

For example the type of premises, its general situation and layout and any other information which could be relevant to the licensing objectives. Where your application includes off-supplies of alcohol and you intend to provide a place for consumption of these off- supplies you must include a description of where the place will be and its proximity to the premises.

PROPOSED SUPERMARKET/CONVENIENCE STORE (FORMER HALAL BUTCHER)

Continued from previous page...

If 5,000 or more people are expected to attend the premises at any one time, state the number expected to attend

Section 6 of 19

PROVISION OF PLAYS

Will you be providing plays?

- Yes No

Section 7 of 19

PROVISION OF FILMS

Will you be providing films?

- Yes No

Section 8 of 19

PROVISION OF INDOOR SPORTING EVENTS

Will you be providing indoor sporting events?

- Yes No

Section 9 of 19

PROVISION OF BOXING OR WRESTLING ENTERTAINMENTS

Will you be providing boxing or wrestling entertainments?

- Yes No

Section 10 of 19

PROVISION OF LIVE MUSIC

Will you be providing live music?

- Yes No

Section 11 of 19

PROVISION OF RECORDED MUSIC

Will you be providing recorded music?

- Yes No

Section 12 of 19

PROVISION OF PERFORMANCES OF DANCE

Will you be providing performances of dance?

- Yes No

Section 13 of 19

PROVISION OF ANYTHING OF A SIMILAR DESCRIPTION TO LIVE MUSIC, RECORDED MUSIC OR PERFORMANCES OF DANCE

Will you be providing anything similar to live music, recorded music or performances of dance?

- Yes No

Continued from previous page...

Section 14 of 19

LATE NIGHT REFRESHMENT

Will you be providing late night refreshment?

- Yes No

Section 15 of 19

SUPPLY OF ALCOHOL

Will you be selling or supplying alcohol?

- Yes No

Standard Days And Timings

MONDAY

Start

End

Start

End

Give timings in 24 hour clock.
(e.g., 16:00) and only give details for the days
of the week when you intend the premises
to be used for the activity.

TUESDAY

Start

End

Start

End

WEDNESDAY

Start

End

Start

End

THURSDAY

Start

End

Start

End

FRIDAY

Start

End

Start

End

SATURDAY

Start

End

Start

End

SUNDAY

Start

End

Start

End

Continued from previous page...

Will the sale of alcohol be for consumption:

- On the premises Off the premises Both

If the sale of alcohol is for consumption on the premises select on, if the sale of alcohol is for consumption away from the premises select off. If the sale of alcohol is for consumption on the premises and away from the premises select both.

State any seasonal variations

For example (but not exclusively) where the activity will occur on additional days during the summer months.

NONE

Non-standard timings. Where the premises will be used for the supply of alcohol at different times from those listed in the column on the left, list below

For example (but not exclusively), where you wish the activity to go on longer on a particular day e.g. Christmas Eve.

NONE

State the name and details of the individual whom you wish to specify on the licence as premises supervisor

Name

First name

Family name

Enter the contact's address

Building number or name

Street

District

City or town

County or administrative area

Postcode

Country

Personal Licence number (if known)

Issuing licensing authority (if known)

Continued from previous page...

PROPOSED DESIGNATED PREMISES SUPERVISOR CONSENT

How will the consent form of the proposed designated premises supervisor be supplied to the authority?

- Electronically, by the proposed designated premises supervisor
- As an attachment to this application

Reference number for consent form (if known)

If the consent form is already submitted, ask the proposed designated premises supervisor for its 'system reference' or 'your reference'.

Section 16 of 19

ADULT ENTERTAINMENT

Highlight any adult entertainment or services, activities, or other entertainment or matters ancillary to the use of the premises that may give rise to concern in respect of children

Give information about anything intended to occur at the premises or ancillary to the use of the premises which may give rise to concern in respect of children, regardless of whether you intend children to have access to the premises, for example (but not exclusively) nudity or semi-nudity, films for restricted age groups etc gambling machines etc.

NONE

Section 17 of 19

HOURS PREMISES ARE OPEN TO THE PUBLIC

Standard Days And Timings

MONDAY

Start

End

Start

End

Give timings in 24 hour clock. (e.g., 16:00) and only give details for the days of the week when you intend the premises to be used for the activity.

TUESDAY

Start

End

Start

End

WEDNESDAY

Start

End

Start

End

THURSDAY

Start

End

Start

End

FRIDAY

Start

End

Start

9 End

Continued from previous page...

SATURDAY

Start

End

Start

End

SUNDAY

Start

End

Start

End

State any seasonal variations

For example (but not exclusively) where the activity will occur on additional days during the summer months.

NONE

Non standard timings. Where you intend to use the premises to be open to the members and guests at different times from those listed in the column on the left, list below

For example (but not exclusively), where you wish the activity to go on longer on a particular day e.g. Christmas Eve.

NONE

Section 18 of 19

LICENSING OBJECTIVES

Describe the steps you intend to take to promote the four licensing objectives:

a) General – all four licensing objectives (b,c,d,e)

List here steps you will take to promote all four licensing objectives together.

AS DETAILED BELOW

b) The prevention of crime and disorder

A CCTV SYSTEM MUST BE MAINTAINED THAT CONFORMS TO THE PROVISIONS OF THE DATA PROTECTION ACT 1998 AND MEETS THE REQUIREMENTS & EXPECTATIONS OF THE LICENSING AND POLICE AUTHORITIES. THE SYSTEM MUST OPERATE AT ALL TIMES THE PREMISES ARE OPEN. RECORDINGS MUST BE KEPT FOR A MINIMUM OF 28 DAYS. A RESPONSIBLE MEMBER OF STAFF MUST BE TRAINED IN HOW TO USE THE SYSTEM AND RETRIEVAL OF RECORDINGS FOR AN OFFICER OF A RESPONSIBLE AUTHORITY.

SPIRITS MUST BE DISPLAYED BEHIND THE SALES POINT

c) Public safety

TO ENSURE THE SAFETY OF CUSTOMERS AND STAFF RISK ASSESSMENTS REQUIRED UNDER SEPARATE LEGISLATION WILL BE MAINTAINED AND REGULARLY UPDATED

Continued from previous page...

d) The prevention of public nuisance

THE PREMISES LICENCE WILL NOT AUTHORISE THE SALE OR SUPPLY OF BEER, LAGER AND/OR CIDER WITH AN ABV IN EXCESS OF 6.5%

AS FAR AS POSSIBLE, BY MANAGEMENT SUPERVISION PATRONS WHO HAVE BEEN SERVED WITH ALCOHOL FOR CONSUMPTION OFF THE PREMISES MUST BE DISCOURAGED FROM CONGREGATING OUTSIDE THE SHOP

e) The protection of children from harm

THE PREMISES TO ADOPT A PROTOCOL OF AGE VERIFICATION WHEREBY ANY PERSON WHO DOES NOT APPEAR TO BE 25 YEARS OF AGE WILL BE REQUIRED TO PRODUCE ID IN THE FORM OF A PASSPORT, PHOTOGRAPHIC DRIVING LICENCE, H M FORCES ID CARD OR AN IDENTIFICATION CARD DISPLAYING THE 'PASS' HOLOGRAM LOGO. A WRITTEN RECORD OF STAFF TRAINING MUST BE KEPT. REFUSALS MUST BE RECORDED AND PRODUCED ON REQUEST OF AN OFFICER FROM A RESPONSIBLE AUTHORITY

Section 19 of 19

PAYMENT DETAILS

This fee must be paid to the authority. If you complete the application online, you must pay it by debit or credit card. Premises Licence Fees are determined by the non domestic rateable value of the premises. To find out a premises non domestic rateable value go to the Valuation Office Agency site at http://www.voa.gov.uk/business_rates/index.htm

Band A - No RV to £4300	£100.00
Band B - £4301 to £33000	£190.00
Band C - £33001 to £87000	£315.00
Band D - £87001 to £125000	£450.00*
Band E - £125001 and over	£635.00*

*If the premises rateable value is in Bands D or E and the premises is primarily used for the consumption of alcohol on the premises then you are required to pay a higher fee

Band D - £87001 to £12500	£900.00
Band E - £125001 and over	£1,905.00

There is an exemption from the payment of fees in relation to the provision of regulated entertainment at church halls, chapel halls or premises of a similar nature, village halls, parish or community halls, or other premises of a similar nature. The costs associated with these licences will be met by central Government. If, however, the licence also authorises the use of the premises for the supply of alcohol or the provision of late night refreshment, a fee will be required.

Schools and sixth form colleges are exempt from the fees associated with the authorisation of regulated entertainment where the entertainment is provided by and at the school or college and for the purposes of the school or college.

If you operate a large event you are subject to ADDITIONAL fees based upon the number in attendance at any one time

Capacity 5000-9999	£1,000.00
Capacity 10000 -14999	£2,000.00
Capacity 15000-19999	£4,000.00
Capacity 20000-29999	£8,000.00
Capacity 30000-39000	£16,000.00
Capacity 40000-49999	£24,000.00
Capacity 50000-59999	£32,000.00
Capacity 60000-69999	£40,000.00

Continued from previous page...

Capacity 70000-79999	£48,000.00
Capacity 80000-89999	£56,000.00
Capacity 90000 and over	£64,000.00

* Fee amount (£)

DECLARATION

* I/we understand it is an offence, liable on conviction to a fine up to level 5 on the standard scale, under section 158 of the licensing act 2003, to make a false statement in or in connection with this application.

Ticking this box indicates you have read and understood the above declaration

This section should be completed by the applicant, unless you answered "Yes" to the question "Are you an agent acting on behalf of the applicant?"

* Full name

* Capacity

* Date / /
dd mm yyyy

Once you're finished you need to do the following:

1. Save this form to your computer by clicking file/save as...
2. Go back to <https://www.gov.uk/apply-for-a-licence/premises-licence/northampton/apply-1> to upload this file and continue with your application.

Don't forget to make sure you have all your supporting documentation to hand.

IT IS AN OFFENCE, LIABLE ON SUMMARY CONVICTION TO A FINE NOT EXCEEDING LEVEL 5 ON THE STANDARD SCALE, UNDER SECTION 158 OF THE LICENSING ACT 2003, TO MAKE A FALSE STATEMENT IN OR IN CONNECTION WITH THIS APPLICATION

OFFICE USE ONLY

Applicant reference number	<input type="text" value="1540"/>
Fee paid	<input type="text"/>
Payment provider reference	<input type="text"/>
ELMS Payment Reference	<input type="text"/>
Payment status	<input type="text"/>
Payment authorisation code	<input type="text"/>
Payment authorisation date	<input type="text"/>
Date and time submitted	<input type="text"/>
Approval deadline	<input type="text"/>
Error message	<input type="text"/>
Is Digitally signed	<input type="checkbox"/>

[< Previous](#) [1](#) [2](#) [3](#) [4](#) [5](#) [6](#) [7](#) [8](#) [9](#) [10](#) [11](#) [12](#) [13](#) [14](#) [15](#) [16](#) [17](#) [18](#) [19](#) [Next >](#)

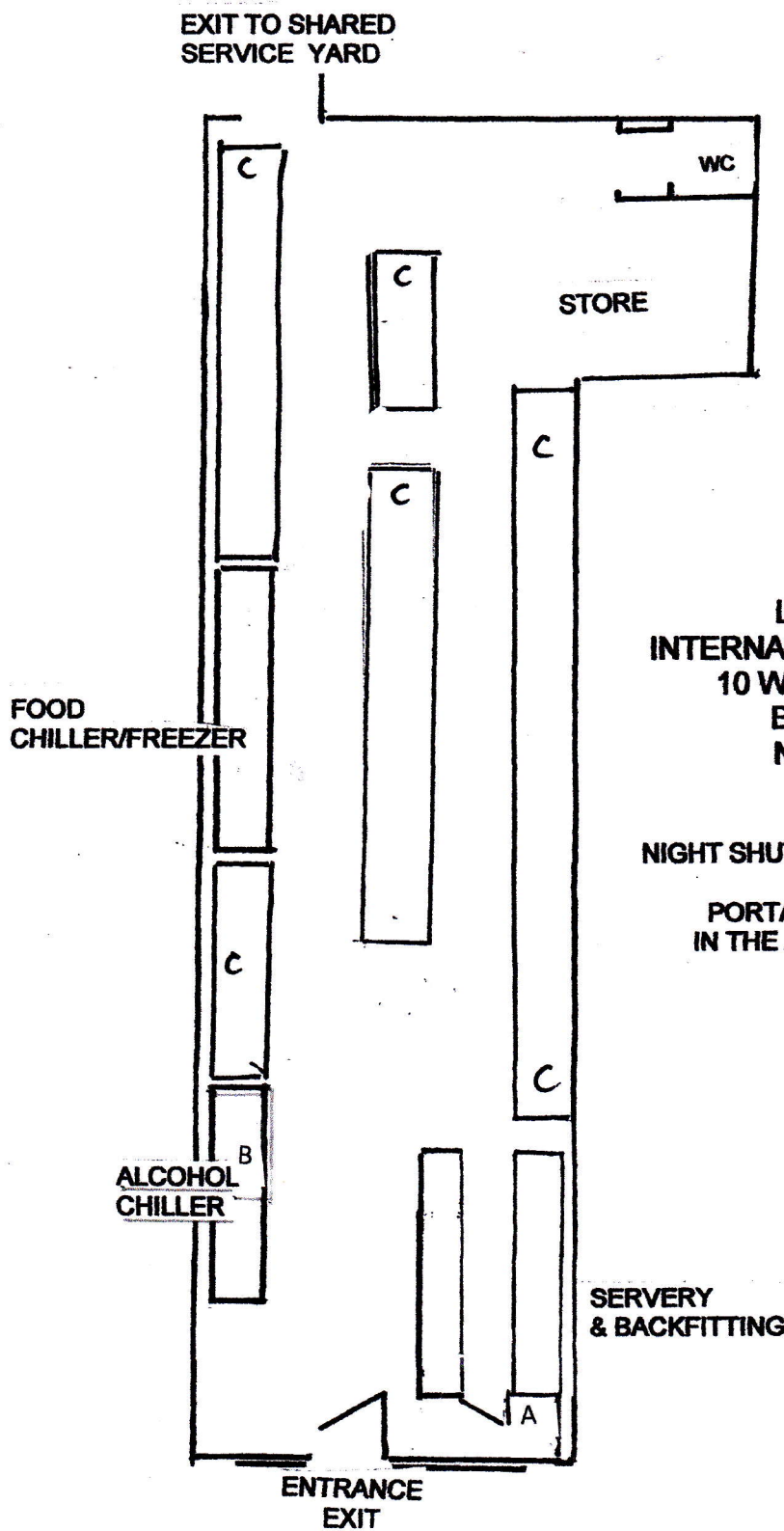

**LITTLE EUROPE
INTERNATIONAL SUPERMARKET
10 WELLINGTON PLACE
BARRACK ROAD
NORTHAMPTON
NN1 3RQ**

NIGHT SHUTTERS TO FRONT AND REAR

**PORTABLE FIRE APPLIANCES
IN THE AREA OF THE SERVERY:
1 X 9LTR WATER
1 X 5 Kg CO2**

P=PILLAR

**A= SERVERY MOVED 1M
HALF HEIGHT DOOR FITTED**

**B=CHILLED BEER
1.5 m TO R/H EDGE**

**C= INDICITVIE
PORTABLE SALES SHELVING**

1:100@A4

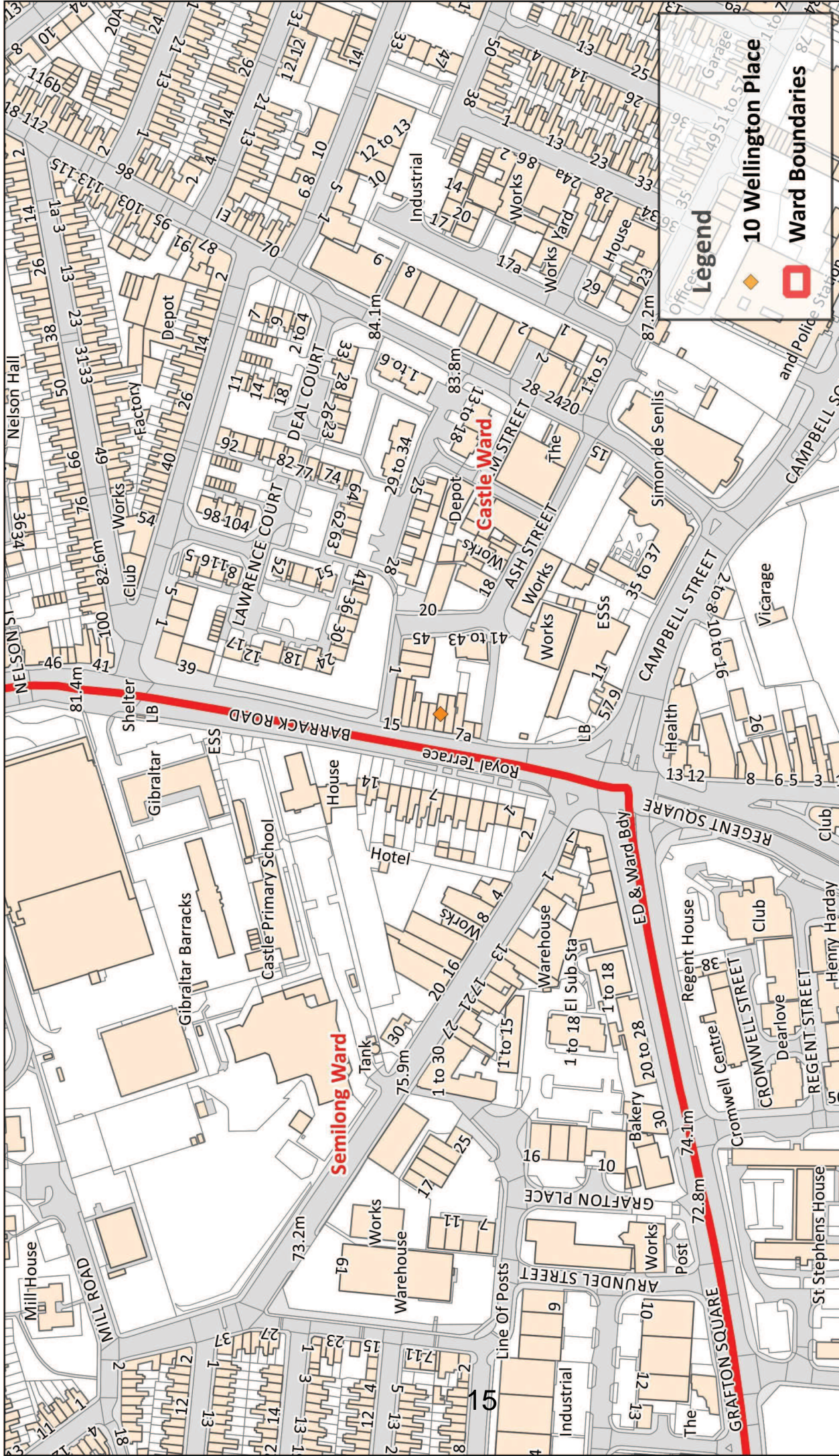

Date: 26-04-2016

Scale: 1:2,500

Drawn by: S Heasman

Title: 10 Wellington Place, Northampton

© Crown Copyright 2014. Reproduced from Ordnance Survey data with the permission of the controller of Her Majesty's Stationery Office. Ordnance Survey is a registered trademark. Northampton Borough Council License Number 100019655.





Northamptonshire County Council

Director of Public Health
Northamptonshire County Council

Dear Sir / Madam,

Ref – licence application in relation to 10 Wellington Place, Barrack Road, Northampton, NN1 3RQ.

As a Responsible Authority under the 2003 Licensing Act, the Director of Public Health makes the following representations in relation to the above licence application.

These representations relate to the following licensing objectives:

- Prevention of crime and disorder
- Public Safety
- The protection of children from harm

Our approach

Northamptonshire County Council has begun screening licensing applications against a series of indicators relating to alcohol harm.

In order to identify geographical areas in the county which experience significant alcohol harm, the Public Health team has identified a number of indicators of alcohol harm and incorporated them into a tool which enables us to compare small geographical areas (Lower Layer Super Output Areas – LSOAs) with other geographical areas with a similar sized population across the county and rank them accordingly. The County is made up of 422 such LSOAs while Northampton Borough is made up of 133 LSOAs.

The indicators used include data in relation to:

- Alcohol liaison nurse service data
- Presentations to Accident & Emergency (A&E) departments with a recorded link to alcohol
- Violent crimes involving alcohol or with an identified link to a licensed premises
- Children's social care data with alcohol misuse identified in relation to an adult in the household
- Alcohol / substance misuse treatment client data, where alcohol misuse is identified
- Extent of existing licensed premises in the location of the area

(More information about the data used is included in the attached appendix)

Public Health & Wellbeing
Northamptonshire County Council
County Hall
Northampton
NN1 1DF

w. www.northamptonshire.gov.uk

t. 01604 368319

e. phlicensing@northamptonshire.gov.uk



Alcohol harm – LSOA Northampton 021C (E01027153)

The premises to which this licence application relates is contained within the LSOA referred to as Northampton 021C (E01027153)

Based on our rankings of alcohol harm, this LSOA is ranked **number 1 of 133 LSOAs in Northampton Borough** and **number 1 of 422 LSOAs in the county** (where 1 indicates the highest levels of alcohol harm).

Specifically:

The number of patients seen by the Alcohol Liaison Nurse during an admission to Northampton General Hospital or Kettering General Hospital (rate per 1000 people) **is the highest of any LSOA in Northampton Borough** (for both single admissions and multiple admissions) **and the 2nd highest in the county for single admissions** and **9th highest in the county for multiple admissions**.

The number of presentations to Accident & Emergency departments (rate per 1000 people) following an assault involving alcohol or where the patient has cited a licensed premises as the location is the **4th highest of any LSOA in Northampton Borough** and **5th highest of any LSOA in the county**.

The number of clients (rate per 1,000 people) receiving treatment within public health commissioned treatment services and with alcohol as the primary problem substance is the **highest of any LSOA in Northampton Borough** and also **the highest of any LSOA in the county**.

The number of existing premises with alcohol licenses (per 1,000 people) in the LSOA falls within the top 10% of all LSOAs in the county. When considering the number of licensed premises within a wider 1km radius of the postcode of the proposed premise, the numbers are very high: - **208** premises licensed to sell alcohol, of which **60** are off licenses.

Further details on these figures are contained in appendix 1.

Alcohol availability and alcohol harm:

There is extensive research which highlights a direct link between the availability of alcohol and alcohol related harm in the surrounding environment, including alcohol related disease and violence (Richardson 2014, NICE 2010, NICE 2014)*

The available research suggests that the density and prevalence of alcohol retail outlets influences alcohol related harm in a variety of ways, including:

- Creating greater physical availability of alcohol in a local area
- Increasing the visibility of alcohol advertising in a local area
- Shaping and reinforcing local attitudes and norms around drinking behaviour and drunkenness.

It is therefore the representation of the Director of Public Health that the licence should **NOT BE GRANTED**, based on the fact that an additional licensed premises is likely to exacerbate the existing high levels of alcohol related harm in this area even further.

Should the licensing authority grant the licence, the Director of Public Health would wish to see the following conditions placed upon the licence:

1. There will be no sales of beers, ciders, or lagers with an alcohol strength higher than 6.5% ABV
2. There will be no window display posters or similar advertising containing any reference to alcohol on the premises shop frontage or the highway abutting the premises.
3. The licensee will be required to display at all times, and in close proximity to all alcohol displays within the premises, the Alcohol Guidelines produced by the UK Chief Medical Officers, and any subsequent guidelines that replace them. The nature of the display material should be approved by the Director of Public Health / Public Health team.
4. The premises will implement the Challenge 25 age verification scheme at all times.
5. All alcohol sale refusals will be recorded in a register which will be retained on the premises for inspection by responsible authorities on request.
6. Staff involved in the sale of alcohol will be provided with information / training regarding alcohol harm. This will be provided by Northamptonshire County Council's Public Health team.
7. All alcohol will be displayed in an area of the shop that enables supervision by staff at all times.

*NICE 2010, Alcohol use disorders: prevention www.nice.org.uk/guidance/ph24
NICE 2014, Alcohol-use disorders: preventing harmful drinking. Evidence Update March 2014
Richardson 2014, Alcohol-related illness and death in Scottish neighbourhoods: is there a relationship with the number of alcohol outlets?



Professor Akeem Ali

LSOA Northampton 021C (E01027153)

Overall county LSOA ranking: 1 (where 1 is the worst).

Northampton 021C	Rate per 1000 People in the LSOA	County Rank (Out of 422)	District Rank (Out of 133)
Alcohol Liaison Nurse (Single Admission)	5.93	2	1
Alcohol Liaison Nurse (Multiple Admissions)	0.99	9	1
Presentations to A+E	11.36	5	4
Violent Crimes	39.51	8	4
Children's Initial Assessments	2.47	118	51
Clients (Alcohol Any)	28.64	1	1
Clients (Alcohol Primary)	19.75	1	1
Clients (Alcohol Any with Children)	1.98	11	4
Clients (Alcohol Primary with Children)	1.48	20	10
Current Licences (On or Both)	4.44	37	10
Current Licences (Off or Both)	3.46	42	9

Rates per 1000 people have been calculated based on the LSOA population estimates 2013.

The number of existing alcohol licences (both indicators) in the LSOA falls within the top 10% of all LSOAs in the county, but is not one of the highest. This is likely to be because it is a geographically small LSOA with a high density of people. When considering the number of licensed premises within a 1km radius of the postcode of the proposed premise, the numbers are very high:

- 208 premises licensed to sell alcohol, of which 60 are off licences.

The following map shows the location of the LSOA and the location of existing premises licensed to sell alcohol in the immediate vicinity.

Map of LSOA Northampton 021C and Surrounding Licensed Premises

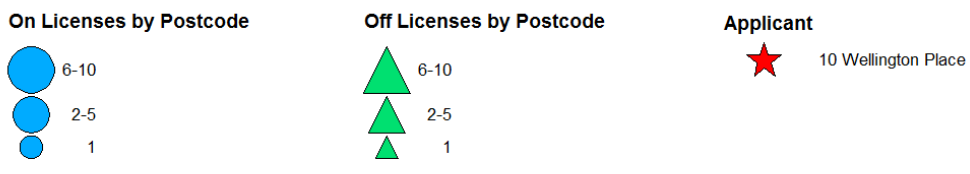
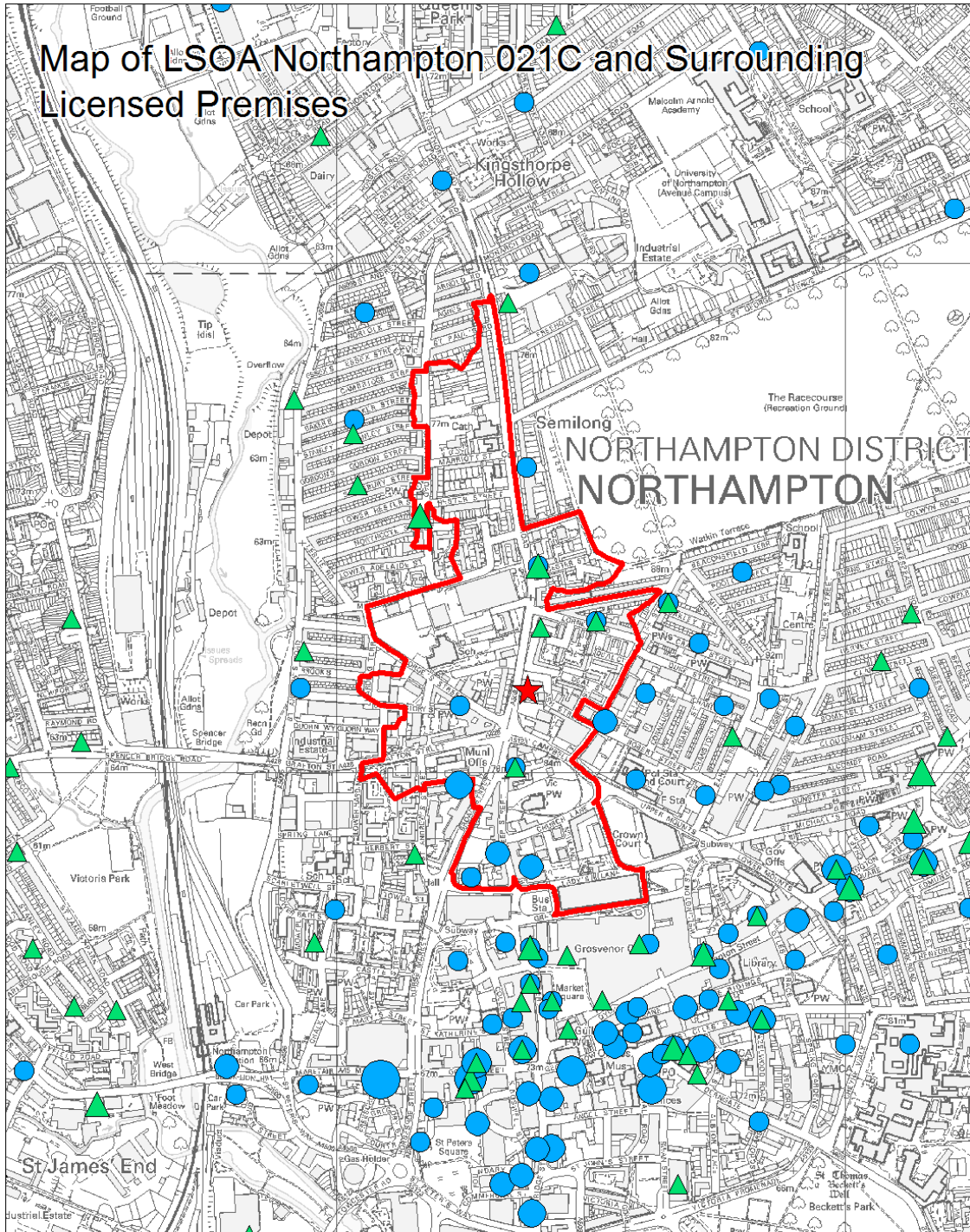

© Crown copyright. This product is produced in part from PAF® and Multiple Residence Data, the copyright for which is owned by Royal Mail Group Limited and/or Royal Mail Group plc. All rights reserved.
 Northamptonshire County Council: Licence No. 100019331. Published 2016.

Indicator Definitions

Alcohol Liaison Nurse (Single Admission)

The number of patients seen by the Alcohol Liaison Nurse during an admission to Northampton General Hospital or Kettering General Hospital. Patients with a single admission during the time period.

(Jan 2014-April 2015)

Alcohol Liaison Nurse (Multiple Admissions)

The number of patients seen by the Alcohol Liaison Nurse during an admission to Northampton General Hospital or Kettering General Hospital. Patients with multiple admissions during the time period.

(Jan 2014-April 2015)

Presentations to A+E

The number of people that have presented to Accident and Emergency at Northampton General Hospital, Kettering General Hospital or the Corby Urgent Care Centre following an assault involving alcohol, or where the patient has cited a licensed premises as the location (either inside or outside).

(April 2014-October 2015)

Violent Crimes

The number of crimes classified and recorded by the Police as 'Violence Against the Person' involving alcohol, or where the victim has cited a licensed premises as the location (either inside or outside).

(April 2014- October 2015)

Children's Initial Assessments

The number of Initial Assessments Northamptonshire Social Services have completed on children where the adult alcohol misuse flag is ticked for an adult in the household.

(July 2013-December 2014)

Clients (Alcohol Any)

The number of people who are in treatment at CRI (substance misuse treatment provider) or a member of Bridge (Recovery Support) for Alcohol abuse, where alcohol is listed as one of the person's three problem substances.

(March 2015-February 2016)

Clients (Alcohol Primary)

The number of people who are in treatment at CRI (substance misuse treatment provider) or a member of Bridge (Recovery Support) for Alcohol abuse, where alcohol is listed as the person's primary problem substance.

(March 2015-February 2016)

Clients (Alcohol Any with Children)

The number of people living with children who are in treatment at CRI (substance misuse treatment provider) or a member of Bridge (Recovery Support) for Alcohol abuse, where alcohol is listed as one of the person's three problem substances.

(March 2015-February 2016)

Clients (Alcohol Primary with Children)

The number of people living with children who are in treatment at CRI (substance misuse treatment provider) or a member of Bridge (Recovery Support) for Alcohol abuse, where alcohol is listed as the person's primary problem substance.

(March 2015-February 2016)

Current Licences (On or Both)

The number of premises licensed to sell alcohol on, or both on and off, the premises.

(Central Licensing Unit as of January 2016, South Northamptonshire Council and Northampton Borough Council as of November 2015)

Current Licences (Off or Both)

The number of premises licensed to sell alcohol off, or both on and off, the premises.

(Central Licensing Unit as of January 2016, South Northamptonshire Council and Northampton Borough Council as of November 2015)

Objection 1

From: Charles Brown
Sent: 13 April 2016 12:51
To: Stevens Lee
Subject: Sales of alcohol Barrack Road

I am e-mailing you with my concerns over the application to sell alcohol from a premises in the Barrack Road (near Marble Arch). I would be totally against this bearing in mind this is an alcohol free area.

In the past before the Night Shelter moved to the end of Bailiff Street it was horrendous working in the area with beer cans and rubbish in the streets. With the cooperation of the Night Shelter, the Police and the local premises owners we managed to control the situation, and when the Night Shelter moved it made working in the area even better. I understand the Hope Centre is re-opening in Ash Street with more people about, with more alcohol available I feel this would be a backward step for people living and working in the here..

Charles Brown

Director
Glass Northampton Limited
25-29 Bailiff Street, Northampton, NN1 3DX

Objection 2

From: Stevens Chris [<mailto:Chris.Stevens@northants.pnn.police.uk>]
Sent: 18 April 2016 10:04
To: Stevens Lee; Williams Rodney; Louise Faulkner
Cc:
Subject: RE: new off licence

Louise,

Please see the below representation from a stakeholder in the local community. I am looking at the representation as being on the grounds of the Prevention of Crime and Disorder, Public Safety and the Prevention of Public Nuisance.

Theresa, could you please forward any correspondence and supporting documentation on to Louise using the email address listed above.

Thanks

Chris
Police Constable 1432 Chris Stevens
Northamptonshire Police Licensing Officer



Prevention and Community Protection
The Guildhall
St Giles Square
Northampton
NN1 1DE

☎ Telephone 101 extension 345730

☎ Mobex: 778816 / 07557778816

✉ chris.stevens@northants.pnn.police.uk

From: Stevens Lee
Sent: 14 April 2016 14:15
To: Williams Rodney <rodney.williams@northants.pnn.police.uk>
Cc: Stevens Chris <Chris.Stevens@northants.pnn.police.uk>
Subject: FW: new off licence

Fyi

Lee

From: Theresa Kelly
Sent: 08 April 2016 12:28
To: Stevens Lee
Subject: new off licence

I would like to express my concern regarding yet another off licence just off the Barrack Road.

The project I manage support in is has a high number of customer who mis use alcohol and have very serious issues with it. Our project is literrlay a 2 minute walk from the proposed off licence.

At present it is hard to support people with their recovery due to the local shops providing a never ending stream of alcohol to anyone. The impact yet another off licence will have is likely to be detrimental to those in recovery. I have no doubt that it will also increase street drinking, yet again, of which we have just managed to reduce.

I hope that this information can be used to look into this issue and avoid the detrimental effect this would have on both our work and our customers recoveries.

Kind regards

Theresa Kelly
Service Manager
NAASH
35 - 37 Campbell Street
Northampton
NN1 3DS

Email: Wed 20/04/2016 07:56

Im unsure what I can give you as hard evidence.

I can say that we have worked recently with local businesses around street drinking which was exceptionally high and causing ASB. We continually have customers on the verge of eviction for alcohol misuse, street drinking, anti-social behaviour in the vicinity of this proposed off licence.

Prior to the work we have done around street drinking with the local shops etc we had daily incidents of customers urinating in the street, threatening shop keepers, my staff having to go and get drunken customers off the street or road.

Without directly quoting from customers files I am unsure how I can give you hard evidence. Apart from the calls that are made either to the police or to us from local businesses.

We have only just got the ASB and street drinking under some control and another off licence comes up

Theresa Kelly
Service Manager
NAASH
35 - 37 Campbell Street
Northampton
NN1 3DS

Objection 3

Email: Wed 20/04/2016 10:04

Stevens Chris <Chris.Stevens@northants.pnn.police.uk>

Louise,

After consulting with my local Safer Community Team colleagues, I wish to register an objection to this application on behalf of the Chief Constable of Northamptonshire Police.

This objection is on the basis of the Prevention of Crime and Disorder, Public Safety and the Prevention of Public Nuisance. The objection will centre around the fact that this area is one that attracts a large number of anti-social behaviour and violence issues and that the presence of this off-licence will lead to an increase in this and jeopardise public safety, and lead to a rise in crime and disorder.

Thanks

Chris
Police Constable 1432 Chris Stevens
Northamptonshire Police Licensing Officer



Prevention and Community Protection
The Guildhall
St Giles Square
Northampton
NN1 1DE

☎ Telephone 101 extension 345730

☎ Mobex: 778816 / 07557778816

✉ chris.stevens@northants.pnn.police.uk

Objection 4

From: PHlicensing [<mailto:PHlicensing@northamptonshire.gov.uk>]

Sent: 18 April 2016 13:10

To: Licensing

Subject: RE: NBC New Grant - 10 Wellington Place LDR: 21/04/2016

Good Afternoon,

Please find attached Public Health's representation and supporting evidence with regards to the above licence application

I would be grateful if you could confirm receipt of this email.

Thank you.

Kind Regards,

Carla Mulchrone
Data Technician
Business Intelligence and Performance Improvement
Northamptonshire County Council

County Hall
Tel: 01604 368319
Email: phlicensing@northamptonshire.gov.uk